

# 4" Accent Luminaires

## LVH4

20-75W MR-16  
 Non-IC Rated  
 120V, 277V or 347V  
 11.5V Secondary

DATE: \_\_\_\_\_ TYPE: \_\_\_\_\_

FIRM NAME: \_\_\_\_\_

PROJECT: \_\_\_\_\_



Aperture: Nominal 4"  
 Ceiling Cutout: 4<sup>3</sup>/<sub>8</sub>"  
 Maximum Ceiling Thickness: 1"  
 For conversion to millimeters,  
 multiply inches by 25.4  
 Not to Scale

### APPLICATIONS:

The LiteFrame™ LVH4 series provides a 4" accent luminaire for a wide variety of commercial and high-end residential projects. Suitable for new construction where insulation, if present, is not installed above or within 3" of the fixture. The LVH4 is ideal for applications that require low profile, uncluttered ceiling planes and dramatic illumination of featured items such as artwork and furnishings. Specify the LVH4 commercially in office, retail, and hospitality spaces, and residentially in bedrooms, living rooms, foyers, and hallways.

### HOUSING:

20 gauge painted steel housing in black. 20 gauge galvanized steel plaster flange.

### OPTICS/REFLECTOR:

Stainless steel lamp retention springs. Borosilicate clear glass lens provided. May be replaced with optional accessories (spread lens, softening lens, beam elongator, or hexal louver). All trims are made of diecast aluminum and reflectors are Alzak® which will not yellow, crack or warp. Matte white trim ring standard. Select trims available in Clear (C), Gold (G), or Black (B) finish or (ST) self-trim ring.

### LAMP/SOCKET:

Bi-pin socket with teflon leads. Integral heat shield. Thermal protector prevents fixture from overheating when improperly installed or over-lamped. Accommodates 20-75W MR-16 lamps. Lamps furnished by others.

### TRANSFORMER:

Magnetic encased transformer. 75VA, 11.5V secondary. Transformer serviceable from below ceiling.

### INSTALLATION:

Self-aligning B-9 bar hangers with integral forked and self-spreading nail tabs. Expands to 24" joist spacing. Bar hangers are suitable for 90° reorientation to housing.

### J-BOX:

Prewired 14 gauge galvanized steel junction box with snap-on cover. J-box is accessible from below ceiling.

### LABELS:

UL approved for all ceiling types. Insulation, if present, must be kept 3" away from housing. UL listed for damp locations and through wiring. CSA certified. Thermally protected. N.Y. City approved.

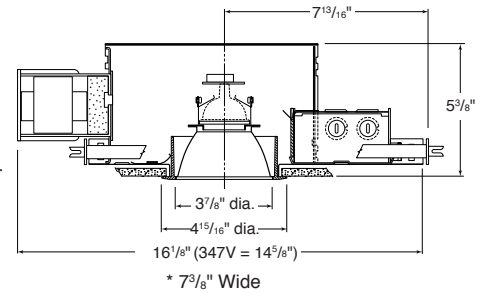

CATALOG NUMBER:

EXAMPLE: LVH4277V-LV1

| HOUSINGS   | HSG OPTIONS   | TRIMS   | TRIMS  | TRIMS  | ACCESSORIES  | ACCESSORIES   | ACCESSORIES  |
|--|---|---|--|--|--|---|--|
| <input type="checkbox"/> <b>LVH4</b><br>4", (1) 20-75W MR-16 Non-IC, low voltage accent luminaire. | <input type="checkbox"/> <b>Blank</b><br>120V, 277V<br><input type="checkbox"/> <b>347V</b><br><input type="checkbox"/> <b>MW35</b><br>Max Wattage label, 35W<br><input type="checkbox"/> <b>MW50</b><br>Max Wattage label, 50W | ADJUSTABLE<br><input type="checkbox"/> <b>LV2</b><br>Black Baffle<br><input type="checkbox"/> <b>LV2B</b><br>Black Alzak<br><input type="checkbox"/> <b>LV2C</b><br>Clear Alzak<br><input type="checkbox"/> <b>LV2G</b><br>Gold Alzak<br><input type="checkbox"/> <b>LV2W</b><br>Matte White<br><input type="checkbox"/> <b>LV2WBF</b><br>White Baffle<br><br>SELF-TRIM<br>ADJUSTABLE<br><input type="checkbox"/> <b>STLV2B</b><br>Black Alzak<br><input type="checkbox"/> <b>STLV2C</b><br>Clear Alzak<br><input type="checkbox"/> <b>STLV2G</b><br>Gold Alzak<br>MIRROR LIGHT<br><input type="checkbox"/> <b>LV9</b><br>Matte White | FRAMING PROJECTOR<br><input type="checkbox"/> <b>LV30</b><br>Matte White<br>OVAL SLOT<br>ADJUSTABLE<br><input type="checkbox"/> <b>LV3</b><br>Matte White<br>PINHOLE<br>ADJUSTABLE<br><input type="checkbox"/> <b>LV5</b><br>Matte White<br>EYEBALL<br>ADJUSTABLE<br><input type="checkbox"/> <b>LV7</b><br>Matte White<br>REGRESSED<br>EYEBALL<br>ADJUSTABLE<br><input type="checkbox"/> <b>LV8</b><br>Black<br>BAFFLE<br><input type="checkbox"/> <b>LV1</b><br>Black<br><input type="checkbox"/> <b>LV1WBF</b><br>White | PINHOLE<br><input type="checkbox"/> <b>LV4</b><br>Matte White<br>LENSED<br><input type="checkbox"/> <b>LV50L</b><br>Matte White<br><input type="checkbox"/> <b>LV50LG</b><br>Gold<br>OPEN<br><input type="checkbox"/> <b>LV1B</b><br>Black Alzak<br><input type="checkbox"/> <b>LV1C</b><br>Clear Alzak<br><input type="checkbox"/> <b>LV1G</b><br>Gold Alzak<br><input type="checkbox"/> <b>LV1W</b><br>Matte White<br>SELF-TRIM<br><input type="checkbox"/> <b>STLV1B</b><br>Black Alzak<br><input type="checkbox"/> <b>STLV1C</b><br>Clear Alzak<br><input type="checkbox"/> <b>STLV1G</b><br>Gold Alzak<br>WALL WASH<br><input type="checkbox"/> <b>LV6</b><br>White | <input type="checkbox"/> <b>LV10</b><br>Linear Spread Lens<br><input type="checkbox"/> <b>LV12</b><br>Isolated spot (for LV8 only)<br><input type="checkbox"/> <b>LV17</b><br>Diffusion Lens<br><input type="checkbox"/> <b>LV18</b><br>Hexal louver<br><input type="checkbox"/> <b>LV19</b><br>Softening lens<br><input type="checkbox"/> <b>LV20</b><br>Mask Kit – replaces shutter assembly in LV30<br><input type="checkbox"/> <b>LV701</b><br>U.V. filter | COLOR FILTERS<br><input type="checkbox"/> <b>LV711</b><br>Medium Pink<br><input type="checkbox"/> <b>LV731</b><br>Light Blue<br><input type="checkbox"/> <b>LV741</b><br>Medium Blue<br><input type="checkbox"/> <b>LV751</b><br>Medium Amber<br><input type="checkbox"/> <b>LV761</b><br>Medium Green<br><br>TRIM OPTIONS<br><input type="checkbox"/> <b>TRG</b><br>Trim ring gasket (factory installed) | <input type="checkbox"/> <b>PKT301</b><br>Converts B-9 bar hangers to supports for 2' grids.<br><input type="checkbox"/> <b>SCA4</b><br>Sloped ceiling adaptor.<br><input type="checkbox"/> <b>TCA2</b><br>Thick ceiling adaptor al lows for use of trims in up to 1 1/2" thick ceilings. Install prior to housing installation. |

# REFLECTORS AND TRIMS

**LiteFrame®**  
4" Incandescent - LVH4

## Adjustable

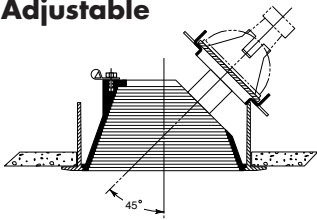

### LV2 Adjustable Baffle

Black diecast milligroove baffle. 45°V x 360°H adjustment with vertical aiming lock. White trim ring.

### LV2WBF Adjustable Baffle

Same as above with matte white baffle. Max. 75W MR-16

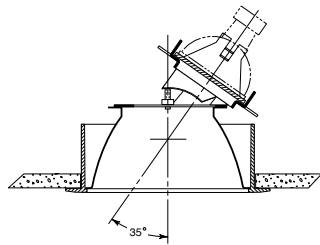

### LV2(B)(C)(G) Adjustable Downlight Reflector

Black (B), clear (C), or champagne gold (G) specular Alzak reflector. 45°V x 360°H adjustment with vertical aiming lock. Matte white trim.

### LV2W Adjustable Downlight Reflector

Adjustable matte white reflector and trim ring.

Max. 75W MR-16

### LV2WBF Adjustable White Baffle

Adjustable matte white reflector and trim ring with matte white baffle.

Max. 75W MR-16

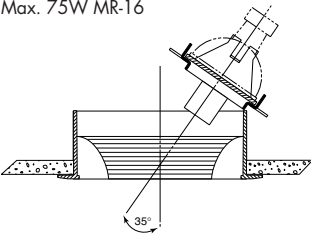

### STLV2B Adjustable Downlight Reflector

Self-trim black Alzak reflector and black Alzak trim ring with 45°V x 360°H adjustment and vertical aiming lock.

### STLV2C Adjustable Downlight Reflector

Same as above with clear Alzak reflector and clear Alzak trim ring.

### STLV2G Adjustable Downlight Reflector

Same as above with gold Alzak reflector and gold Alzak trim ring.

Max. 75W MR-16

## Oval Slot Adjustable

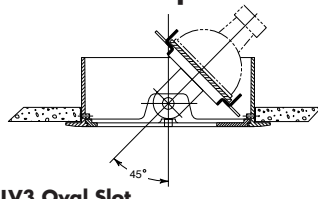

### LV3 Oval Slot

Matte white Oval slot with 45°V x 360°H adjustment and vertical aiming lock. Matte white trim ring. Max. 75W MR-16

## Pinhole Adjustable

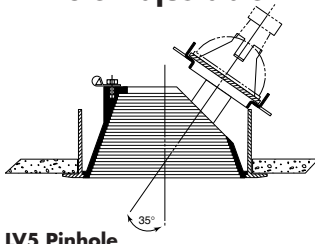

### LV5 Pinhole

Adjustable pinhole spot with black baffle. Matte white trim. 35°V x 360°H adjustment. Vertical locking mechanism. Max. 75W MR-16

## Eyeball Adjustable

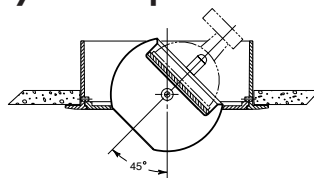

### LV7 Adjustable Eyeball

White surface eyeball with 45°V and 360°H adjustment. Matte white trim ring. Max. 75W MR-16

## Regressed Eyeball Adjustable

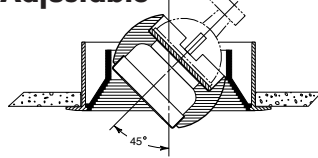

### LV8 Regressed Eyeball

Black regressed eyeball with black baffle. 45°V x 360°H adjustment with vertical aiming lock. Matte white trim ring. Max. 75W MR-16

## NOTES

Refer to [www.prescolite.com](http://www.prescolite.com) for additional photometric tests (IES Files).

## Baffle

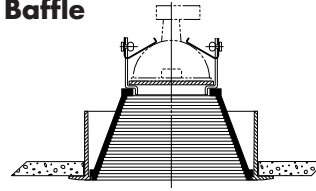

### LV1 Baffle

Fixed black diecast milligroove baffle. Matte white trim ring.

### LV1WBF White Baffle

Same as above with matte white baffle. Max. 75W MR-16

## Pinhole

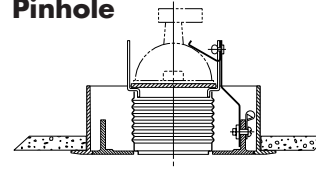

### LV4 Pinhole - Milligroove Baffle

Fixed pinhole spot with black milligroove baffle and matte white trim ring. Max. 75W MR-16

## Lensed

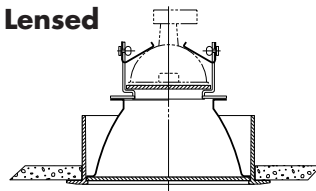

### LV50L Shower Lens

Solite® glass lens shower trim with matte white trim ring. Solite lens offers low brightness viewing with excellent light transmission at nadir. Wet location approved.

### LV50LG Shower Lens

Same as above with gold trim ring. Max. 75W MR-16

## Mirror Light

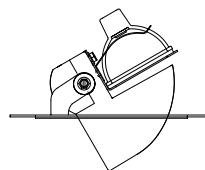

### LV9 Mirror Light

Reference specification sheet LFR-INC-029. Max. 75W MR-16

## Open

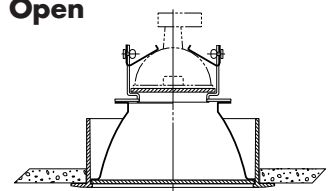

### LV1(B)(C)(G) Static Downlight Reflector

Fixed black (B), clear (C), or champagne gold (G) specular Alzak® reflector. Matte white trim ring.

### LV1W Static Downlight Reflector

Matte white reflector and white trim ring. Max. 75W MR-16

## Self-Trim

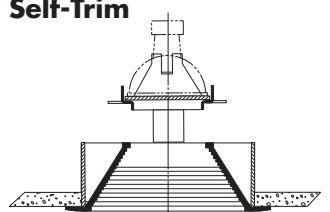

### STLV1B Downlight Reflector

Self-trim black Alzak open reflector and black Alzak trim ring.

### STLV1C Downlight Reflector

Same as above with clear Alzak reflector and clear Alzak trim ring.

### STLV1G Downlight Reflector

Same as above with gold Alzak reflector and gold Alzak trim ring.

Max. 75W MR-16

## Wall Wash

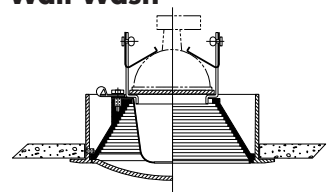

### LV6 Wall Wash

Matte white eyelid wall washer with interior black baffle, interior kicker reflector and formerly LV17 spread lens. Matte white trim ring.

Max. 75W MR-16

## Framing Projector

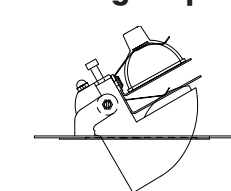

### LV30 Framing Projector

Reference specification sheet LFR-INC-030. Max. 75W MR-16